



Product Catalogue

2013/2014

Index



IMPRESSION MATERIAL

2

- Image™ Alginate **3**
- Image Syringable™ **5**
- Hydrocolloid **5**
- Impression Trays **8**
- Impression Taking Accessories **10**

- PeelVue+™ Sterilization Pouches **13**
- Steri-Cage™ **17**
- Cleaning Products **17**
- Bib-Eze™ **18**

INFECTION CONTROL

12

TISSUE MANAGEMENT

20

- Retraction Cords **21**
- Haemostatic Solutions **23**

- ZONE™ Temporary Cement **25**
- Mixing Pads **25**
- ZONEfree™ Temporary Cement **26**

TEMPORARY CEMENTS

24

ACCESSORIES

28

- Trays and Accessories **29**
- Tubs and Accessories **29**
- Bur Blocks **30**
- X-Ray Viewer **31**
- Mirrors **31**

IMPRESSION MATERIAL





Image™ Alginate

Image Alginate is a dust free alginate with a pleasant mint odour, creamy and easy to mix. Image Alginate provides a bubble-free, glass-like and smooth surface texture and creates unsurpassed stone models. The green colour makes Image easy to read and kids just love it. Image Alginate is 100% biodegradable.

- **Special water-loving formula**
The uniform particle size assures a precise rate of absorption. All ingredients are soluble at the same rate yielding a quick uniform mix and a smooth surface texture.
- The **smooth surface texture** with a glass-like finish provides amazing detail. You will see the difference in your perfect stone models and in your provisional restorations!
- **Reduced storage space.** Image Alginate is packaged in 0,5 kg polyaluminum bags to increase shelf life and the unique canister design features a cutout for convenient storage of both scoop and vial.

Image fast set (2 min.)

- A Canister 0,5 kg** 27416
Canister, 0,5 kg bag, scoop and vial
- A Value Pack 5 kg** 27417
10 bags of 0,5 kg, canister, scoop and vial
- A Refill Pack 5,5 kg** 27419
11 bags of 0,5 kg
- A Institutional Pack 15 kg** 27460
30 bags of 0,5 kg

Image regular set (3 min.)

- A Canister 0,5 kg** 27426
Canister, 0,5 kg bag, scoop and vial
- A Value Pack 5 kg** 27427
10 bags of 0,5 kg, canister, scoop and vial
- A Refill Pack 5,5 kg** 27429
11 bags of 0,5 kg
- A Institutional Pack 15 kg** 27461
30 bags of 0,5 kg
- B Water vial for Image Alginate** VA 001
- B Powder scoop for Image Alginate** SA 007

Image Alginate Singles™

Each unit contains the exact amount of alginate for one impression (18 g). Once cut open at the dotted line, the unit acts as a water vial to add the right amount of water to the alginate powder. Image Alginate Singles ensure the right viscosity of your mix every time!

- **Quality:** Always the right measure of alginate and water. The mixture viscosity will be exactly the same every time
- **Convenient:** No more space consuming alginate canister or bag
- **Efficient:** No need to use a scoop and vial to measure alginate and water
- **Hygienic:** No more unwashed water vial lying around gathering bacteria
- C Image Alginate Singles** 27412
52 individual pouches of 18 g (2 min. set)



Alginator™ mixing machine

The proven mixer that takes the work out of mixing alginates and stone. The Alginator makes a smooth, virtually bubble-free mix while eliminating waste and reducing clean-up time. The alginite bowl is latex free.

- A single mixing speed for a smooth, bubble-free alginite mix every time
- Perfect portability and ergonomics
- A sleek design that will perfectly complement any operator

A Alginator **25241**

Incl.: alginite bowl medium, spatula and spray bottle Clean & Lube (120 ml) and 0,5 kg Image Alginate (regular set 3 min.), canister, scoop and vial.

Accessories

B Alginite Bowl (medium) **25236**

B Stone Bowl (large) **25252**

C Spatula, alginite-type **25234**

Clean and Lube™ Spray Bottle

Used on alginite bowls between mixes for cleaning and keeping bowls from drying out while reducing bowl abrasion. Clean & Lube Spray keeps alginite bowls flexible and looking like new. Clean & Lube Spray effectively removes alginite and stone residue from bowls and will not discolour your alginite bowls.

D Clean & Lube Spray **23070**
Spray bottle (120 ml)

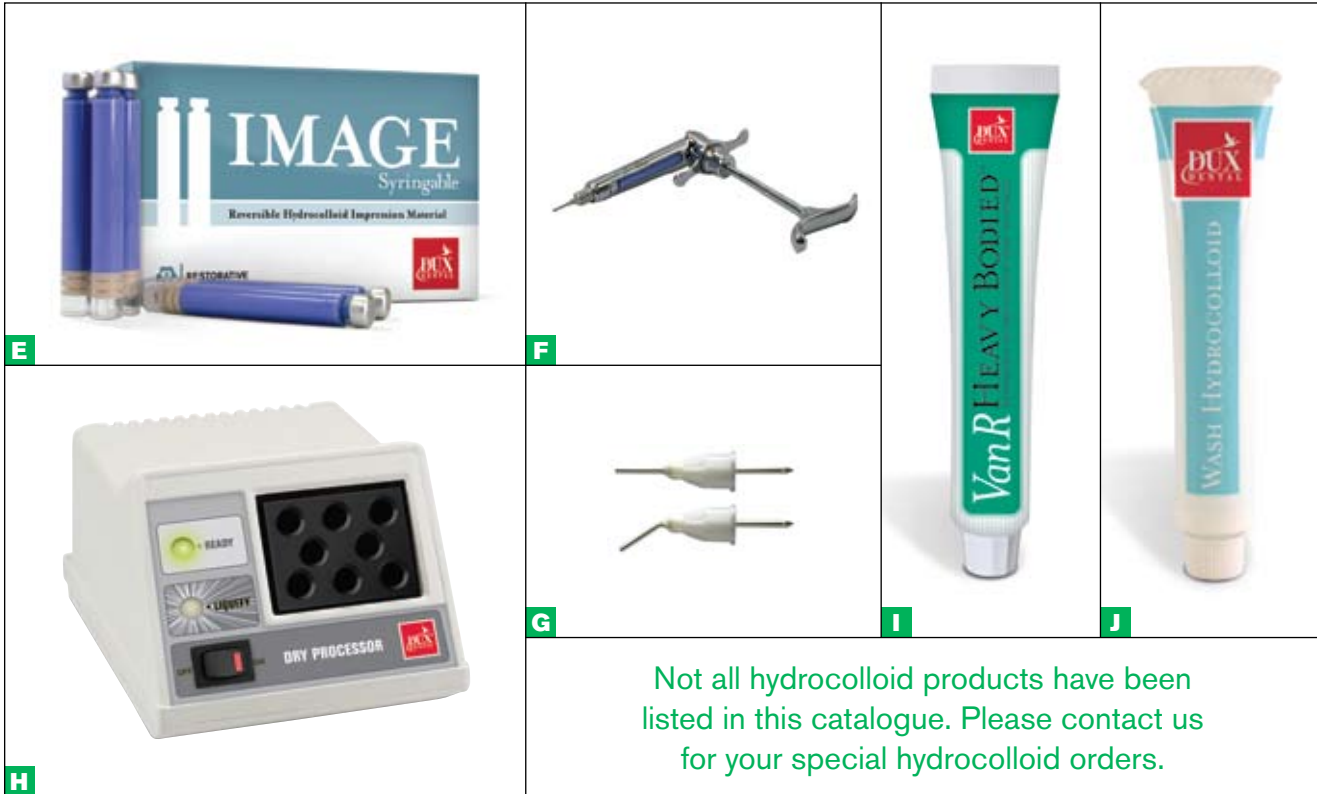

Not all hydrocolloid products have been listed in this catalogue. Please contact us for your special hydrocolloid orders.

Image Syringable™

Image Syringable is a two component system that bonds hydrocolloid syringe material to dust-free alginate tray material. The consistent accuracy and wet field application of hydrocolloid combined with the speed and ease of taking an alginate impression makes this system ideal for precise crown, bridge, inlay and only impression taking. The dentist obtains an accurate and cost-effective impression while conveniently operating in a naturally wet mouth; the dental assistant has only to load a CartriLoid into a syringe and mix alginate; the patient has a comfortable procedure that lasts only 60 seconds.

- E** **Image Syringable starter kit** **21601**
Incl.: Image Alginate (Regular set – 3 min.) 1 kg; Image Syringable Cartridges, Blue, box of 48; Disposable needles 18G, box of 100; Metal Syringe for cartridges; Bottle Extend-A-Pour
- F** **Image Syringable Hydrocolloid cartridges** **21600**
Blue, box of 48
- G** **Image Syringable Metal Syringe** **11053**
(Cartriloids 1,8 ml)
- H** **Disposable Needles 18 G** **11049**
Box of 100 needles

DryProcessor II

Liquefaction/storage unit, for use with Image Syringable Hydrocolloid materials.

- H** **DryProcessor II 220V** **25320**
- H** **DryProcessor II Starter Package** **25300**
Including: DryProcessor II 220V; Image Syringable Starter Kit (Conf. Ref. 21601)

VanR Hydrocolloid

Reversible Hydrocolloid Tray Material

VanR reversible hydrocolloid is the most precise and detailed impression material available in dentistry. No other material such as polyether or A-silicon will provide the consistency and detail of hydrocolloid. Your crowns and bridges will fit perfectly, every time again; Always the same superb result. VanR Hydrocolloid is a safe, natural product without chemicals and will not provoke allergic reactions. Because hydrocolloid is 100% biodegradable, it will not be harmful to the environment, after disposal.

VanR Heavy Bodied™ - Green 60 g

- Standard by which all impressions are judged
- Tempers for 7 minutes at 43°C
- Cool 5 minutes in the mouth
- Storage after liquefaction: 5 days

- I** **Regular pack** **11012**
Box of 12 poly tubes
- I** **Large pack** **11011**
Box of 12 regular packs
- I** **Econ-O-Pack** **11014**
Box of 144 individual poly tubes

VanR Wash Reversible Hydrocolloid

One-step technique for making reversible hydrocolloid impressions; eliminates the need for a syringe for full-coverage crown impressions. Maximum tempering time is 7 minutes. Storage after liquefaction: 5 days.

- J** **Regular pack** **11070**
Box of 12 poly tubes



A

β-Tron™ Hydroprocessor

Maintain maximum control with minimum effort. Three interchangeable plug-in units contain all the electronic components, microcomputers, and heating elements for easy use, convenient servicing.

The β-Tron features automatic liquefaction from any starting water temperature and automatically corrects for absolute temperature control. An energy-conserving proportioned control system is provided to eliminate the constant cycling of heating elements.

Separate display panels indicate the temperature of each bath, while function lights indicate liquefying and timing modes. Audible signals inform when materials are liquefied and when they are ready for use in the mouth. There are also special displays to warn of power interruptions and low water levels. The β-Tron is factory programmed with preset temperatures and is ready to use. Temperatures and timers may be easily reprogrammed by the operator if desired.









B

A B-Tron 101 15535

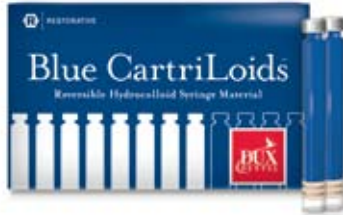
- 1 bath unit: Boil, Store (or Temper)
- Width: 15 cm
- Depth: 25 cm
- Height: 26 cm (lid closed), 41 cm (lid open)
- Weight: 2.6 kg
- Electrical: 230 V- 400 W- 2A- 50 Hz.

B B-Tron 301 15517

- 3 bath unit: Boil/Auxiliary Store, Store and Temper
- Width: 41 cm
- Depth: 25 cm
- Height: 26 cm (lids closed), 41 cm (lids open)
- Weight: 6.8 kg
- Electrical: 230 V- 1200 W- 3x2A- 50 Hz.

 <p>C</p>	 <p>E</p>	 <p>I</p>
 <p>D</p>	 <p>F</p>	
 <p>G</p>	<p>VanR Hydrocolloid is clinically the most precise and economical dental impression material available. No other material such as polyether or A-Silicon provides so much detail. The hydrocolloid impression should be stored in a 100% moist environment and be poured out within 45 minutes with Super Hard Gypsum, for best results. However, it is possible to delay impression pouring up to 4 weeks after the impression is immersed in Extend-A-Pour.</p> <p>Prof. Dr. Alexander Gutowski, Germany</p>	
 <p>H</p>		

Hydrocolloid Syringe Material

Glass CartriLoids containing 1,8 ml of hydrocolloid for up to four preparations. SuperCartriLoids contain 3,6 ml of hydrocolloid and can be used for up to 9 preparations.

Syringe Material – Pink

Light viscosity – for displacement use

CartriLoids

Glass cartridges, 1,8 ml

C Box of 48 CartriLoids 11040

C Case of 288 CartriLoids 11060

SuperCartriLoids

Glass cartridges, 3,6 ml

D Box of 24 CartriLoids 11065

Syringe Material – Blue

Heavy viscosity – for placement use

CartriLoids

Glass cartridges, 1,8 ml

E Box of 48 CartriLoids 11038

E Case of 288 CartriLoids 11062

SuperCartriLoids

Glass cartridges, 3,6 ml

F Box of 24 CartriLoids 11068

CartriLoid Needles

Disposable blunt-end 18 gauge needles for CartriLoids and SuperCartriLoids. These needles can be bent up to a 90° angle without restricting flow.

G Box of 100, white 11049

CartriLoid and SuperCartriLoid Syringes

CartriLoid metal syringe, non-aspirating (anaesthetic type)

H CartriLoid Syringe 11053

For use with 1,8 ml CartriLoids

H SuperCartriLoid Syringe 11067

For use with 3,6 ml SuperCartriLoids

CartriLoid/SuperCartriLoid Basket

Stainless steel basket that holds 8 CartriLoids or 5 SuperCartriLoids.

I Metal CartriLoid Basket 11058



A



B

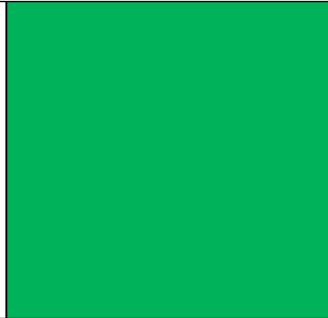

C

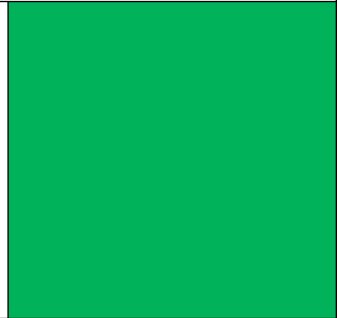

Hydrocolloid Starter Package

Materials recommended for use with reversible hydrocolloid.

- A Hydrocolloid Starter Package 15507**
- 24 Tubes of Heavy Bodied Green Rev. Hydrocolloid
- 48 Pink CartriLoid Syringe Material
- 100 18 gauge blunt-end CartriLoid Needles
- 12 Tubes of Wash Rev. Hydrocolloid
- 10 Full Arch Water-Cooled Trays
(4 Medium: 2 each of upper and lower)
- (1 each of Small, Large, Extra-Large: upper and lower)
- 2 Half Arch Water-Cooled Trays
- 2 Anterior Water-Cooled Trays
- 1 CartriLoid Metal Syringe
- 1 CartriLoid Basket
- 1 Tubing for Water-Cooled Trays w/quick disconnects
- 1 Bottle of Potassium Sulphate (550 g)
- 1 Box of Tacky Stops
- 1 Prep Wet Kit.
- 1 Box of Post Damming Plastic
- 1 Bottle of Extend-A-Pour (355 ml)

Impression Trays

Impression Trays (Alginate)

DUX Dental provides a complete line of trays, both solid and perforated. Durable and non-staining. Rim lock design holds all impression materials in place. The maxillary arch trays have special buccal tabs adjacent to the second bicuspid, which aid in removing the tray from the mouth. Can be sterilized up to 180°C.

Solid Impression Trays, "Rim-Lock"

- Regular Set, Solid 28099**
Set incl. 8 solid trays, 1 of each type listed below
- B RS, Small Upper Solid Tray28100**
- C RS, Small Lower Solid Tray28101**
- B RM, Medium Upper Solid Tray28104**
- C RM, Medium Lower Solid Tray28105**
- B RL, Large Upper Solid Tray28106**
- C RL, Large Lower Solid Tray28107**
- B RXL, X Large Upper Solid Tray28108**
- C RXL, X Large Lower Solid Tray28109**

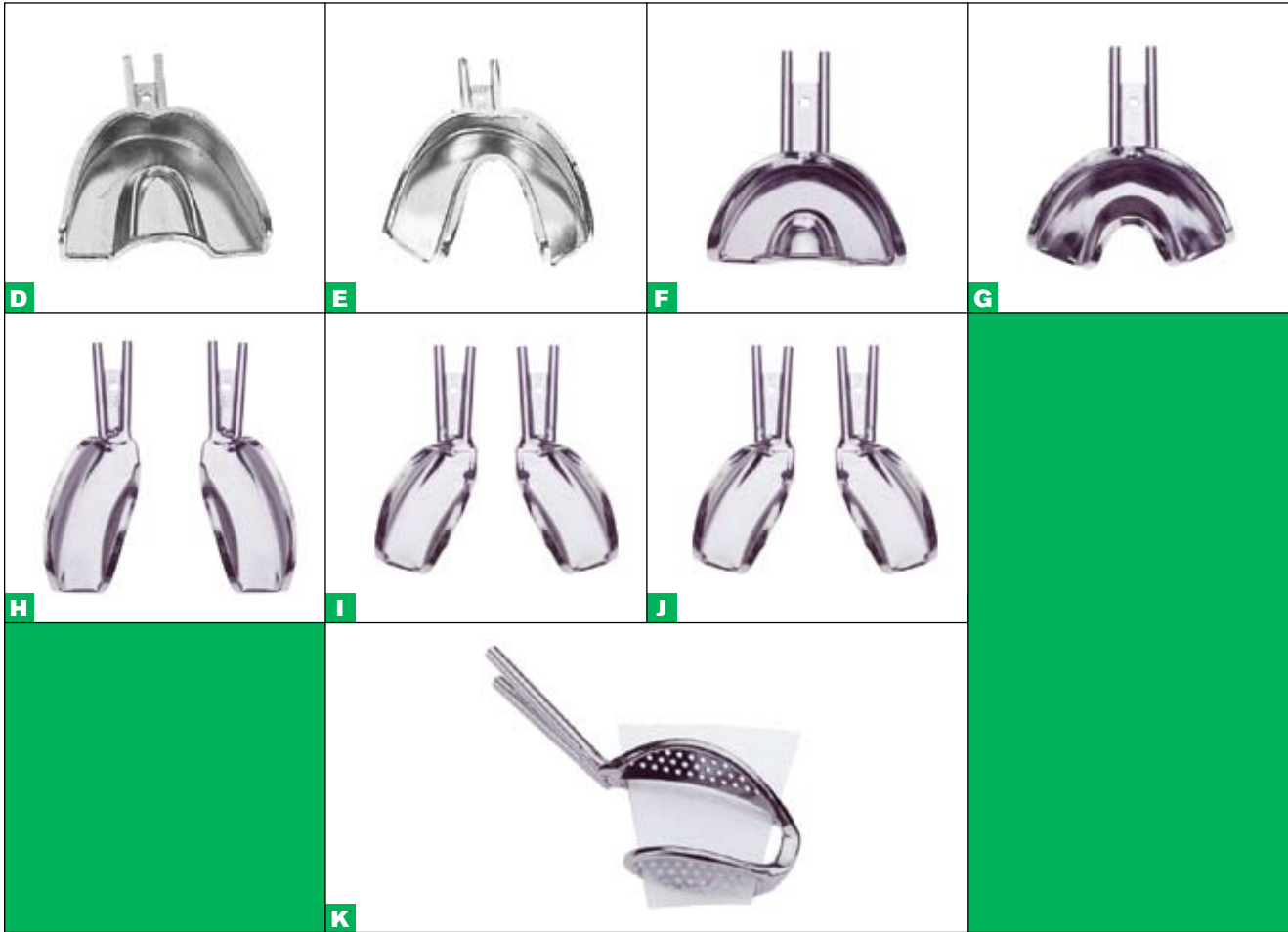

Water Cooled Impression Trays (Hydrocolloid)

DUX Dental provides a complete line of water-cooled impression trays. The high-quality brass construction with chrome plating assures long lasting durability and rapid, even cooling of Rev. hydrocolloid impression materials. The maxillary arch trays have a special buccal tab adjacent to the second bicuspid which aids in removing the tray from the mouth. The mandibular arch trays feature a wider posterior flange for correct insertion, easy removal and added patient comfort. Can be sterilized up to 180°C.

D	Full Arch Small Upper	12202
D	Full Arch Medium Upper	12204
D	Full Arch Large Upper	12206
D	Full Arch X Large Upper	12208
E	Full Arch Small Lower	12203
E	Full Arch Medium Lower	12205
E	Full Arch Large Lower	12207
E	Full Arch X Large Lower	12209
F	Anterior Tray Upper	12218
G	Anterior Tray Lower	12219

H	Inlay Tray	12227
	Upper Left/Lower Right	
H	Inlay Tray	12228
	Upper Right/Lower Left	
I	Quadrant (partial) Tray	12216
	Upper Left/Lower Right	
I	Quadrant (partial) Tray	12217
	Upper Right/Lower Left	
J	1/2 Arch	12220
	Upper Left/Lower Right	
J	1/2 Arch	12221
	Upper Right/Lower Left	
K	Double Bite Tray	12248
	perforated	
K	Occlusal Inserts	12249
	for Double Bite Tray (pkg. of 25)	



Tubing

- A Black silicone Tubing** 12231
6 feet

HVE Adaptor

Allows high volume suction to be used when cooling Hydrocolloid impressions, freeing up the saliva ejector for oral evacuation. Fits between disconnect and HVE and connects with tubing to HVE. Silent operation.

- B HVE Adaptor** 12244

Tray Connector for Tubing

- Black** 12246

Tacky Stops (Tray Preparation)

Disposable, self-adhesive, occlusal stops which adhere to the occlusal surface of trays. Tacky Stops prevent over-seating of the tray.

- C Tacky Stops** 12051
Box of 300 pc

Post Damming Plastic

Used to contain Reversible Hydrocolloid in a maxillary tray and to increase compression for maximum displacement during seating of the tray. The tray must be clean and dry with no trace of glove powder for best adherence.

- D Packaging 340 g** 13061
56 pre-cut strips, (76 x 12 x 3 mm)

Periphery Plastic

Designed to augment tray height. Also used along the peripheral edge of trays for patient comfort or for a peripheral roll. The tray must be clean and dry with no trace of glove powder for best adherence to the tray.

- E Packaging 340 g** 13060
49 pre-cut strips, (127 x 19 x 6 mm)

Impression Taking Accessories

Extend-A-Pour™

An impression storage solution designed for use with hydrocolloid and alginate. Enables the dental practice to delay impression pouring for up to 4 weeks after the impression is immersed.

- F Extend-A-Pour** 13005
Bottle (355 ml)

Clean and Lube™ Spray Bottle

To be used on Alginate bowls between mixes for cleaning and keeping bowls from drying out while reducing bowl abrasion. Clean & Lube Spray keeps alginate bowls flexible and looking like new. Clean & Lube Spray effectively removes alginate and stone residue from bowls and will not discolour your alginate bowls.

- G Clean & Lube Spray** 23070
Spray bottle (120 ml)

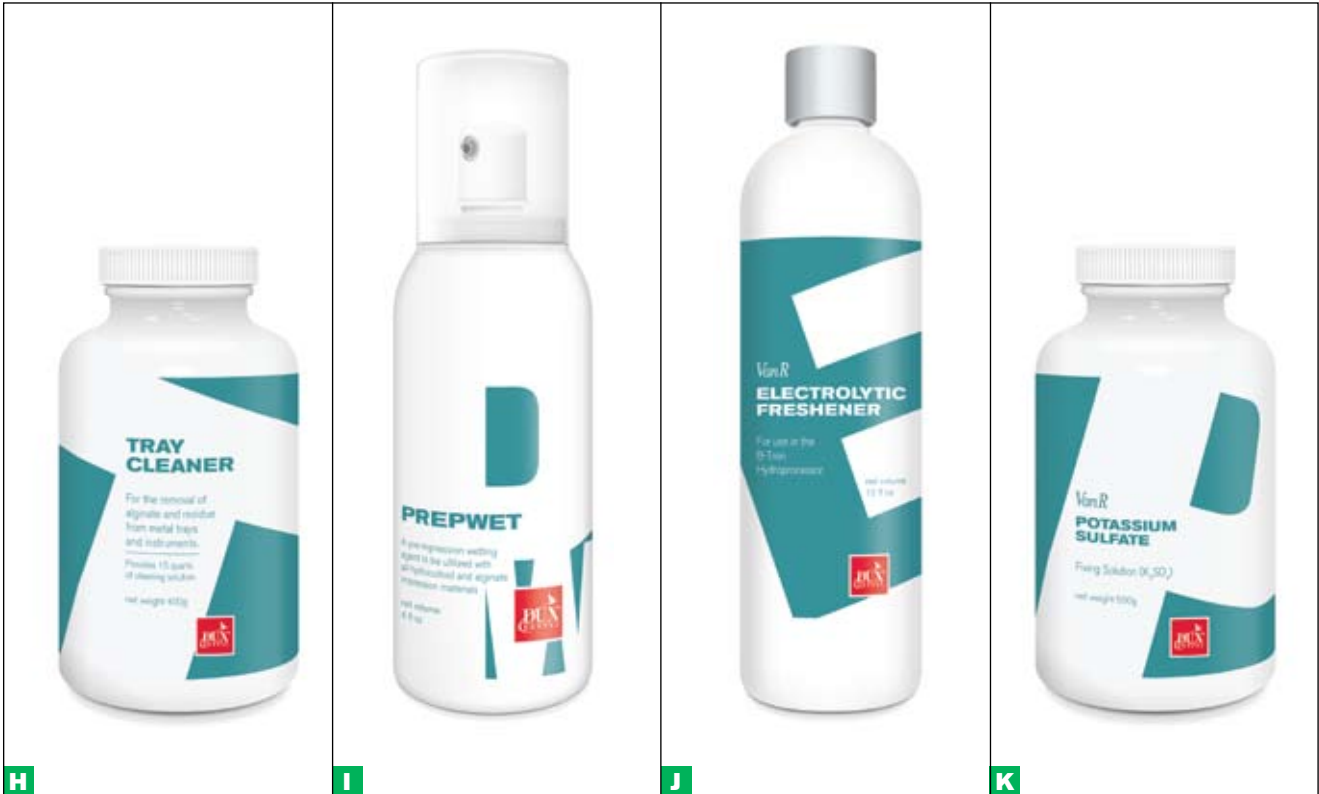

Tray Cleaner

Concentrated granular formulation may be mixed for immediate scrubbing or as a twenty minute soak for impression trays.

- H Tray Cleaner** **24035**
Bottle (400 g)

PrepWet™

A lubricant which is sprayed over the entire arch after the retraction cord is removed to allow the Reversible Hydrocolloid syringe material to flow freely through the sulcus and for easy removal of the impression tray.

- I PrepWet Kit** **13097**
3 Spray bottles of each 120 ml and 100 Dispenser Straws
- Dispenser Straw** **13096**
Box of 100

Electrolytic Freshener

Allows low-water sensing devices to operate in areas with very pure or distilled water. For use in the B-Tron Hydroprocessor.

- J Electrolytic Freshener** **15496**
Bottle (355 ml)

Potassium Sulphate

Improves stone hardness and keeps moisture from evaporating from the Rev. Hydrocolloid impression. Used as a 2% immersion solution prior to pouring the stone. For longer storage see Extend-A-Pour. Two scoops Potassium Sulphate crystals to 4 litres of water yields a 2% solution.

- K Potassium Sulphate 550 g** **13001**
Canister (includes measuring cap)

INFECTIONCONTROL



Don't take safety for granted. Use the PeelVue+ pouch

Safety

External and **patented Internal Processing Indicators** built directly into each pouch.

Vents located on either side of the internal indicator to allow the **same ambient conditions** inside and outside the pouch.

10 mm broad, safe seal.

Closure Validation

(triangles) mark the exact position to close the adhesive flap.

Convenience

A pre-applied sealing tape with a unique non-adhesive edge for **easy peel and seal** of the pouch – even with gloves.

The self-adhesive **19 mm wide sealing tape** is designed into the pouch, making a heat sealing machine superfluous.

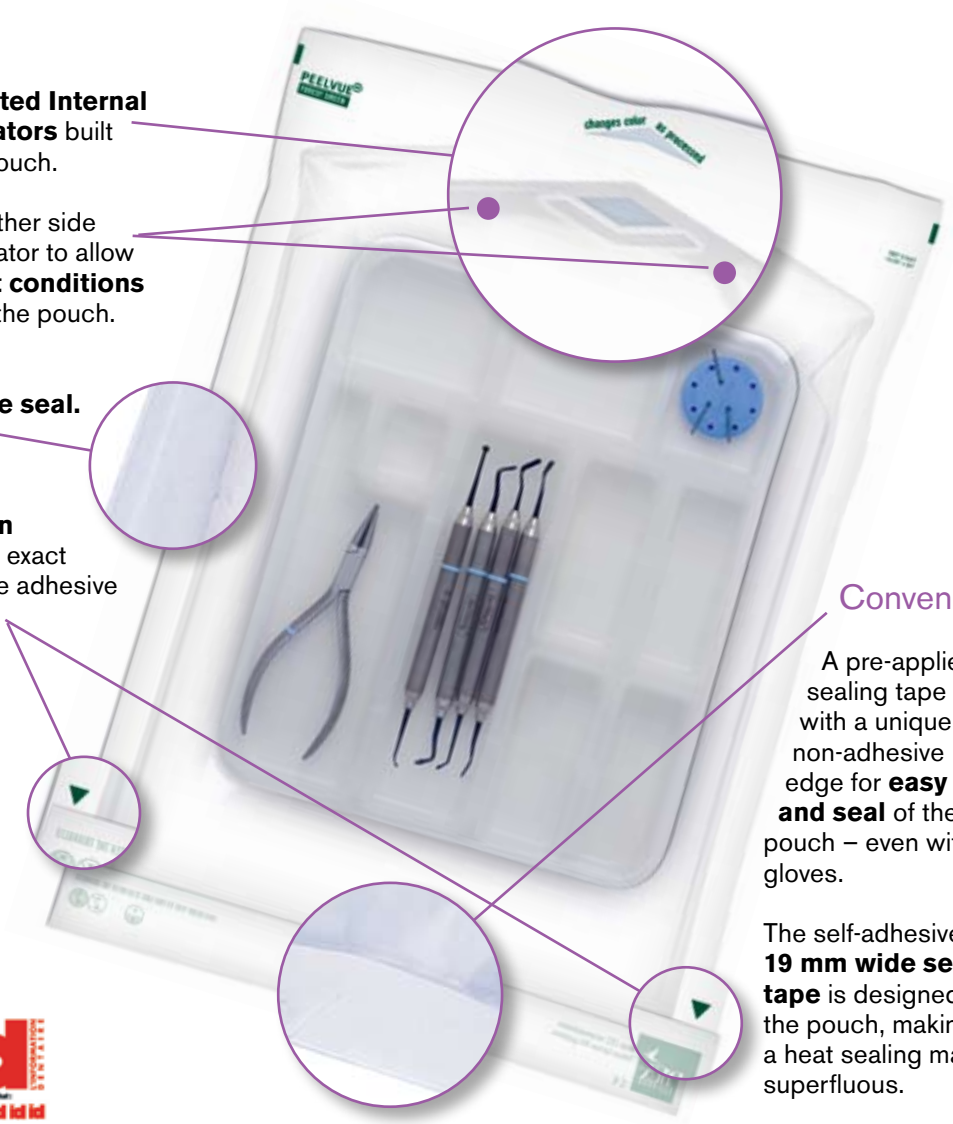

PeelVue+™ Sterilization Pouches

PeelVue+ is the recommended packaging method for moist heat sterilizing, sterile storage and presentation of instruments and accessories to the patient. When the peel able clear film is removed, preferably chair-side, the instruments can be left on the sterilized paper surface, demonstrating impressively to the patient the dentist's concern for infection control.

- With Closure Validation (patent pending)
- Easy to close and peel open
- Self-sealing
- Patented Internal and external Processing Indicator
- For safe use in any steam Auto/Chemiclave
- Contains medical-grade, virgin, non-recycled paper
- Lead-free inks

- Clear film easy removable for rapid instrument access
- Paper side of pouch can function as a sterilized tray liner
- 200 pouches per box

The multiple instrument size pouches (REF 31619, 31618, 31615, 31643 and 31645) are designed to hold complete sets of colour-coded procedure instruments. All currently available cassettes can be accommodated in a specific PeelVue+ pouch that is sized accordingly. After removing the clear film, the paper side of the pouch can function as a sterilized tray liner.

PeelVue+™ sterilization pouches comply with the U.S. CDC, ADA and the German RKI guidelines. ISO 11607



PeelVue+ Sterilization Pouches with closure validation!

PeelVue+ 90 x 135 mm

Implants, Dam Clamps

- A** Box of 200 pouches 31610
- A** Case of 10 boxes x 200 pouches 31620

PeelVue+ 70 x 230 mm

Hand pieces, Hand Instruments

- B** Box of 200 pouches 31611
- B** Case of 10 boxes x 200 pouches 31621

PeelVue+ 90 x 230 mm

Hand pieces, Hand Instruments

- C** Box of 200 pouches 31612
- C** Case of 10 boxes x 200 pouches 31622

PeelVue+ 55 x 100 mm

Burs

- D** Box of 200 pouches 31613
- D** Case of 10 boxes x 200 pouches 31623

PeelVue+ 135 x 165 mm

Impression Trays, Bur Blocks

- E** Box of 200 pouches 31614
- E** Case of 10 boxes x 200 pouches 31624

PeelVue+ 215 x 380 mm

Multiple Instruments and cassettes

- F** Box of 200 pouches 31615
- F** Case of 5 boxes x 200 pouches 31625

PeelVue+ 85 x 305 mm

Hand Instruments (long)

- G** Box of 200 pouches 31616
- G** Case of 10 boxes x 200 pouches 31626

PeelVue+ 110 x 305 mm

Surgical, Orthodontic

- H** Box of 200 pouches 31617
- H** Case of 10 boxes x 200 pouches 31627

PeelVue+ 205 x 305 mm

Multiple Instruments, small cassettes

- I** Box of 200 pouches 31618
- I** Case of 5 boxes x 200 pouches 31628

PeelVue+ 135 x 305 mm

Multiple Instruments

- J** Box of 200 pouches 31619
- J** Case of 10 boxes x 200 pouches 31629

PeelVue+ 265 x 405 mm

Large cassettes

- K** Box of 200 pouches 31643
- K** Case of 5 boxes x 200 pouches 31653

PeelVue+ 335 x 510 mm

Large Cassettes (I.M.S. Type)

- L** Box of 200 pouches 31647
- L** Case of 5 boxes x 200 pouches 31657



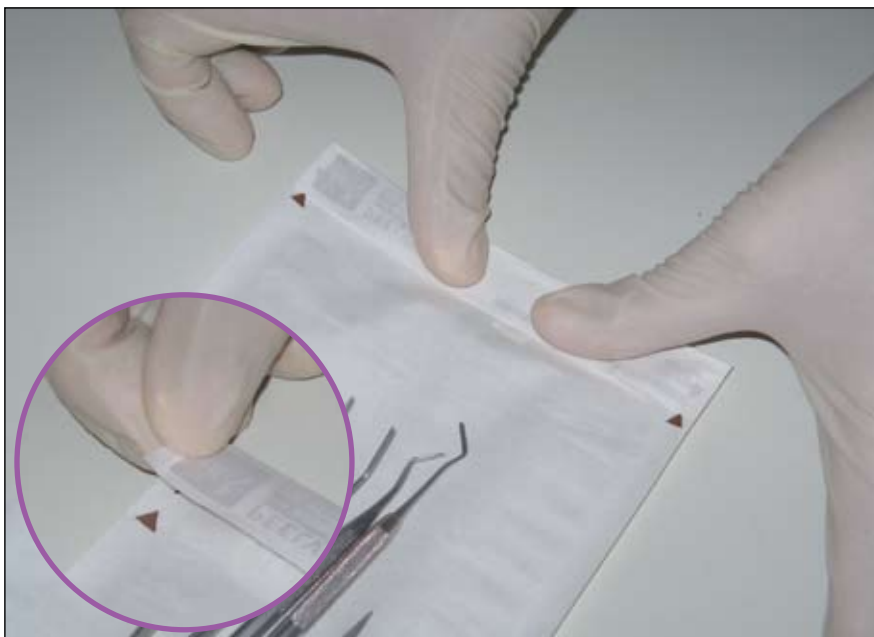

Closure Validation:
Triangles mark
the exact position
to close the
adhesive flap.



Correct



Incorrect

PeelVue⁺ sterilization pouches comply with all relevant directives for sterile instrument packaging and are appropriately certified. That makes PeelVue⁺ sterilization pouches suitable for all auto/Chemiclave sterilization requirements in the dental office.

To guarantee the quality of the process, this guideline and validation instruction specifies the correct use of PeelVue⁺ sterilization pouches.



This QMS supporting document can be downloaded at
www.duxdental.com.



Steri-Cage™

Can be cleaned under running water without removing the instruments.

- 200 x 45 x 45 mm
 - Auto-/Chemiclavable
 - Can be immersed in all sterilizing and disinfecting solutions
 - Cassettes may be placed in PeelVue+ sterilization pouches prior to sterilization
 - Safe in all sterilizing and disinfecting solutions.
 - Easily accommodated in PeelVue+ pouch
- Ref. 31615 ■

A French Vanilla ○ .. 32506	Baby Blue ● 32511
Sand ○ 32507	White ○ 32512
Light Mauve ● 32508	Grey ● 32513
Sea Foam ● 32509	Beige ● 32514
Lilac ○ 32510	Ice ○ 32515

Cleaning Products

AeroSpense Dispensing System

Packaged in 275 ml pre-filled aerosol dispensing cans. The solution is dispensed directly onto gauze/tissue by finger pressure. No lids or caps to remove. Economical dispensing system that prevents spills and evaporation.

- B Orange Solvent, AeroSpense 23041**
A non-stinging formula of orange oil and skin emollients in a mild solvent base. Used for patient cleanup on lips after zinc oxide is used. Also used for cleaning instruments, fingers, mixing slabs, etc.
- C Isopropyl Alcohol, AeroSpense 22041**
Convenient dispensing method wherever alcohol is routinely used.

Orange Solvent Citro-Gold

Citro-Gold is ideal for removal of zinc oxide pastes and rubber base materials from instruments, trays and hands while leaving a pleasant orange scent.

- D Orange Solvent Citro-Gold 23031**
P.E.T. Bottle of 475 ml (also available in Aerospense 22041)



Bib-Eze™

Hygienic disposable bib holders

Bib-Eze. The hygienic solution to avoid the 'yuck' factor and to eliminate the contamination risk.

- Easy application: peel and stick adhesive edge
- Patient comfort: soft crepe paper
- Stretches to fit: one size fits all
- No cleaning: never clean a bib chain again
- Single use: discard with bib into trash

A Bib-Eze Box of 250 pc35053

Surveys show that bib chains and clips are on the radar as potential sources of contamination. A bib chain can 'grab' onto hair or accumulate patient's sweat, make-up, hair products, neck acne, dermatitis, etc in the crevices and inaccessible areas of the holder. Yet not many dental offices have taken steps to protect their patients. Separate studies have concluded that dental bib chains and clips do carry a cross-contamination risk and that risk should not be ignored.

Avoid bib chain contamination risk



Use Bib-Eze™ Hygienic disposable bib holders!

L. Markovic, A.K. Stemmermann, S. Zimmer "Microbial contamination of patient bib holders". Witten/Herdecke University, Faculty of Health, School of Dentistry, Department of Operative and Preventive Dentistry, December 2011, Germany.
 John A. Molinari, Ph.D. - Microbial Contamination of Patient Napkin Holders THE DENTAL ADVISOR Biomaterials Research Center Dental Consultants, Inc., Ann Arbor, Michigan; Juni 2010.
 UNC School of Dentistry, Chapel Hill, North Carolina. Bib Chain Contamination Study, On file with DUX Dental.
 N. Kelsch, RDH. Don't Clip that Crud on Me. RDH. Januar 2010.

The science speaks for itself:

- 1 out of 5 bib clips showed significant presence of microorganism growth and some were found to harbour the opportunistic pathogen pseudomonas and overt pathogens Staphylococcus aureus and the enteric bacteria, *E. coli*.
- Microbial contamination was found on both metal and coiled plastic napkin holders after use during patient care. Most of the isolated bacteria were environmental bacteria and/or components of the skin or oral cavity.
- Bib clips and other items can be a source of cross-contamination. Bib chains and other napkin holders can harbour pathogens in their crevices.

TISSUE MANAGEMENT

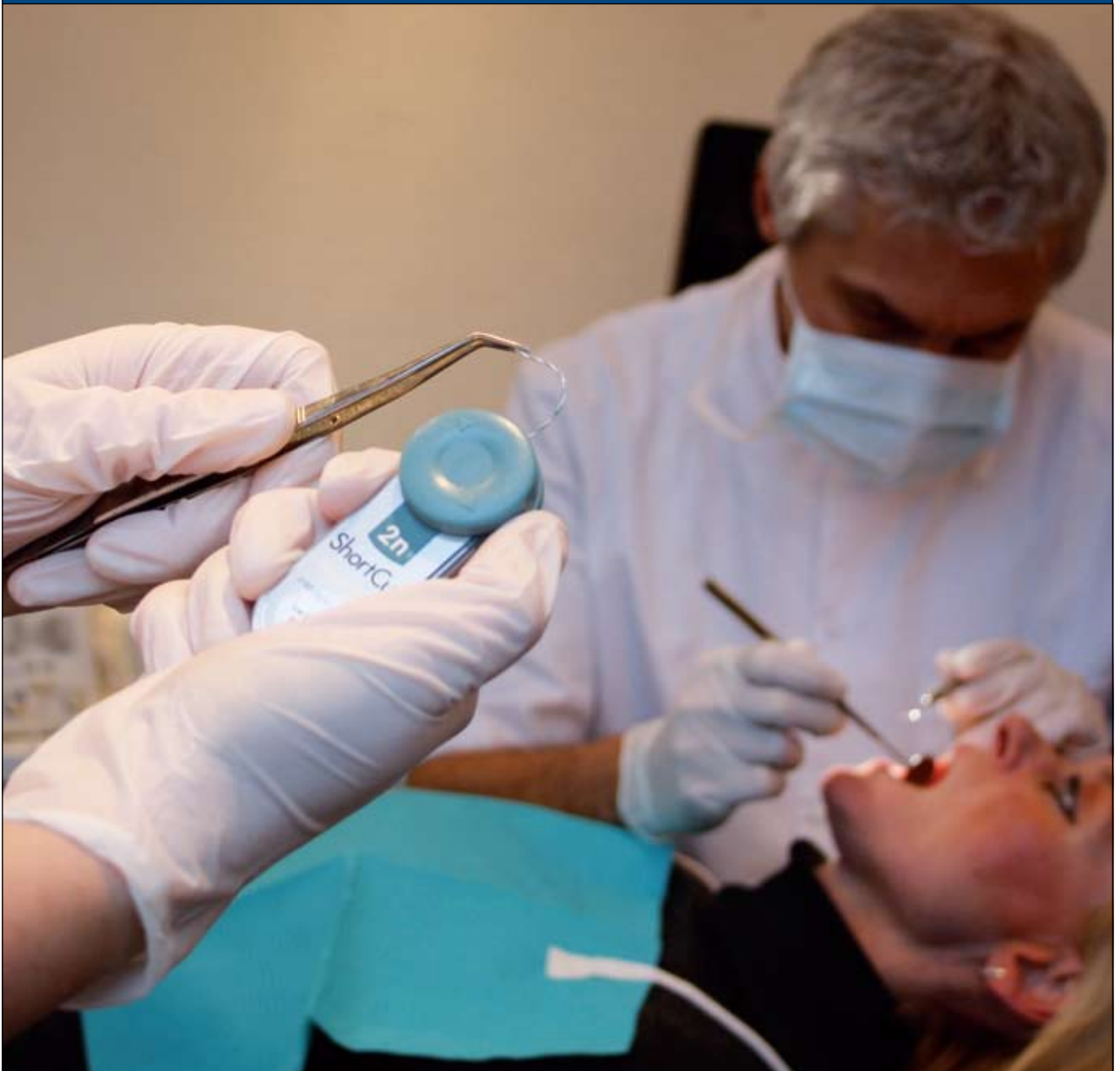

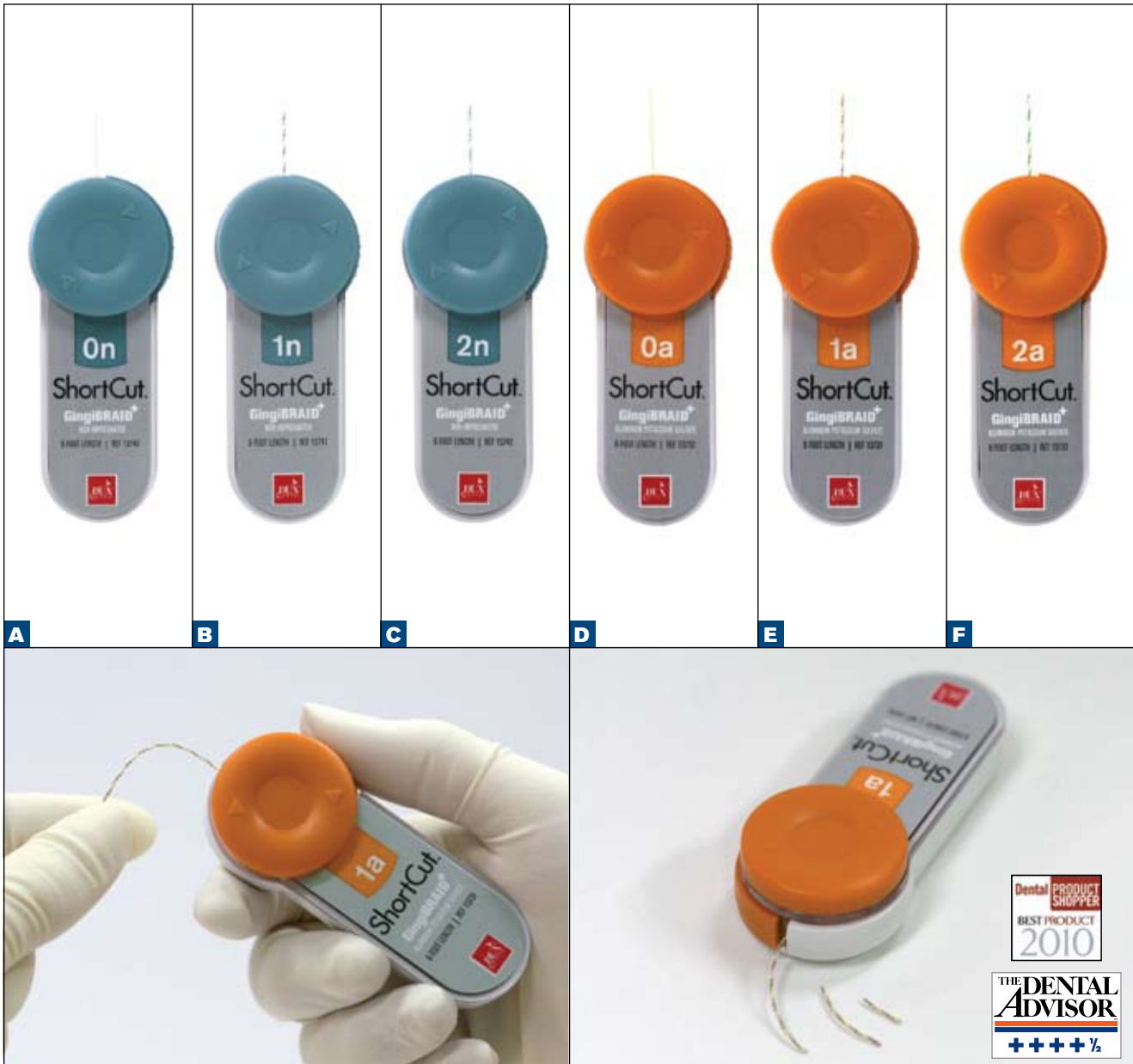

Retraction Cords

DUX Dental has the most extensive selection of tissue management materials available, satisfying every operator's use and technique. In addition to braided and knitted cord also non-impregnated or impregnated cord with a 10% aluminum chloride solution is available.

ShortCut™ - Retraction Cord Dispenser

- All-in-one-system that fits comfortably in the hand
- Built-in cutter, no need for scissors
- Rotary mechanism dispenses each time the same amount of cord with a simple click (1cm)
- Durable, waterproof label
- Improved hygiene control
- Available non-impregnated or impregnated with 10% aluminum potassium sulfate.
- Sizes: 0 (thin), 1, 2 (thick)
- GingiBraid+ retraction cord inside
- 183 cm cord per ShortCut

ShortCut - non-impregnated

- A** ShortCut size 0n 13740
- B** ShortCut size 1n 13741
- C** ShortCut size 2n 13742

ShortCut - impregnated with 10% aluminum potassium sulfate

- D** ShortCut size 0a 13730
- E** ShortCut size 1a 13731
- F** ShortCut size 2a 13732





A



B

GingiBraid+™ - Braided Retraction Cord

Specially treated braid for faster absorption allowing immediate use and effectiveness. Braided retraction materials are made of cotton fibre that will not split or collapse in the sulcus. Available in 4 diameters, aluminum potassium impregnated and non-impregnated. The retraction braids have a background colour (for medicament identification) with a different colour strand running through the braid for diameter identification.

- High absorbency
- Background colour
- Less memory effect
- Easier placement
- Faster acting haemostasis
- Packing instrument does not penetrate the cord while placing
- 183 cm cord per bottle

GingiBraid+ Impregnated

- A** Size 0a, yellow 13210
- A** Size 1a, yellow w/purple strand 13211
- A** Size 2a, yellow w/green strand 13212
- A** Size 3a, yellow w/pink strand 13213

GingiBraid+ Non-Impregnated

- B** Size 0n, white 13217
- B** Size 1n, white w/purple strand 13214
- B** Size 2n, white w/green strand 13215
- B** Size 3n, white w/pink strand 13216



C

GingiGel™ - Gel-Coated Braided Retraction Cord

This braid is made of synthetic fibre and packaged in a haemostatic gel containing 20% buffered aluminum chloride. This thorough saturation allows easy placement and immediate haemostatic results. The gel keeps the braid soft and pliable to prevent “pop-out.”

- Saturated in buffered Aluminium Chloride gel 20%
- Immediate control of bleeding
- Easy manipulation of the cord
- 183 cm cord per bottle

- C** Size 1 13165
- C** Size 2 13166
- C** Size 3 13167



GingiKNIT places easily without fraying or memory and the cotton fiber won't "pop-out".

GingiKNIT™ - Knitted Retraction Cord

Constructed of many tiny, absorbent loops knitted in long, interlocking chains, GingiKNIT is placed easily without fraying or memory, and the cotton fibre won't "pop-out." GingiKNIT conforms to the anatomy of the sulcus with gentle, outward force and cuts clean if touched by a high-speed cutting instrument. Available in 6 diameters, impregnated and non-impregnated.

- Allows to finesse margins after the knit has been packed into the sulcus
- Will not fray or be removed if touched by a high-see cutting instrument
- Easily packed without popping out of the sulcus
- 183 cm cord per bottle

GingiKNIT Impregnated

(aluminum potassium sulphate 10%)

- Size 000a, yellow 13508
- Size 00a, yellow w/black strand 13509
- D** Size 0a, yellow w/orange strand 13510
- Size 1a, yellow w/orange-black strand .. 13511
- Size 2a, yellow w/red strand 13512
- Size 3a, yellow w/red-black strand 13513

GingiKNIT Non-Impregnated

- Size 000n, white 13498
- Size 00n, white w/black strand 13499
- Size 0n, white w/orange strand 13500
- E** Size 1n, white w/orange-black strand 13501
- Size 2n, white w/red strand 13502
- Size 3n, white w/red-black strand 13503



F

Haemostatic Solutions

Styptin™ (Cranberry Flavoured)

A fast-acting, 20% buffered aluminium chloride haemostatic solution in a lubricating base.

- Cranberry flavour
- The blue colour shows the operator where the solution is placed
- The increased viscosity prevents the solution from migrating from the site
- The squeeze bottle allows easy dispensing and minimizes the possibility of cross-contamination

- F** Styptin 13157
15 ml squeeze bottle
- F** Styptin 13156
30 ml refill bottle

TEMPORARY CEMENTS





ZONE™ Temporary Cement (Zinc Oxide, Non-Eugenol)

DUX Dental's family of ZONE Temporary Cement products is formulated completely free of eugenol. All ZONE products are low in water solubility and resistant to breakdown in the oral environment, thus providing long-lasting results. ZONE cement has a 30 second mixing time and a 2-minute working time.

- Hard setting crystalline cement which permits easy removal and clean up
- Assures consistent superior retention
- Will not soften, crack, craze or discolour acrylic or polycarbonate crowns
- Kind to tissue, nerve endings and pulp
- Will not decalcify dentin
- Non-toxic
- Available in various dispensers

- A ZONE Temporary Cement Kit 27040**
Kit includes tube of base and catalyst and mixing pad
- B ZONE Temporary Cement Syringe 27043**
Dual barrel syringe 15 g

- C ZONE Temporary Cement Unit Dose 27039**
Box of 25 units
- D ZONE Temporary Cement AutoMix Syringe 27047**
Syringe 4 g, including 8 static mixing tips
- Static Mixing Tips 27048**
Package of 8 tips

Mixing Pads

- Non-slip
 - Waterproof backing
 - Each sheet is plastic-coated on both sides
 - Compatible with all dental materials
 - No penetration of material from one sheet to the next
 - Available in five sizes
- E Size 0, Extra Small 31092**
Package of 12 pads, 30 x 40 mm
 - E Size 1, Small 31093**
Package of 8 pads, 80 x 70 mm
 - E Size 2, Medium 31094**
Package of 4 pads, 80 x 130 mm





A



*When loading the
provisional
ZONEfree is still
white*

*When seating the
provisional
ZONEfree becomes
translucent*

ZONE™ temporary cements
combine superior, longlasting
retention with easy removal
and clean up!

ZONEfree™ Translucent Temporary Cement

(Translucent, Zinc Oxide, Non-Eugenol)

ZONEfree is the world's first translucent (lighttransmissive), non-eugenol zinc oxide dental cement for prostheses.

- Unites all ZONE™ properties (see page 25)
- Translucent
- Ideal for aesthetic dentistry
- Easy to remove without leaving a rubber-like residue (zinc oxide base)
- Rapid hardening in the mouth (2 minutes)
- Contains no triclosan and no eugenol
- Available in convenient Automix syringe

A ZONEfree Temporary Cement Syringe.....27041

Automix Syringe, 4 g including 8 static mixing tips

A new generation of temporary cement!

Prismatic nanofillers create a 'chameleon effect': applied thinly, ZONEfree adapts to the colour of adjacent surfaces, becoming virtually invisible as a result!



Direct and fast loading with the Automix Syringe



The provisional is held in place with firm pressure.



Easy removal of excess cement



Excellent aesthetic results



ACCESSORIES



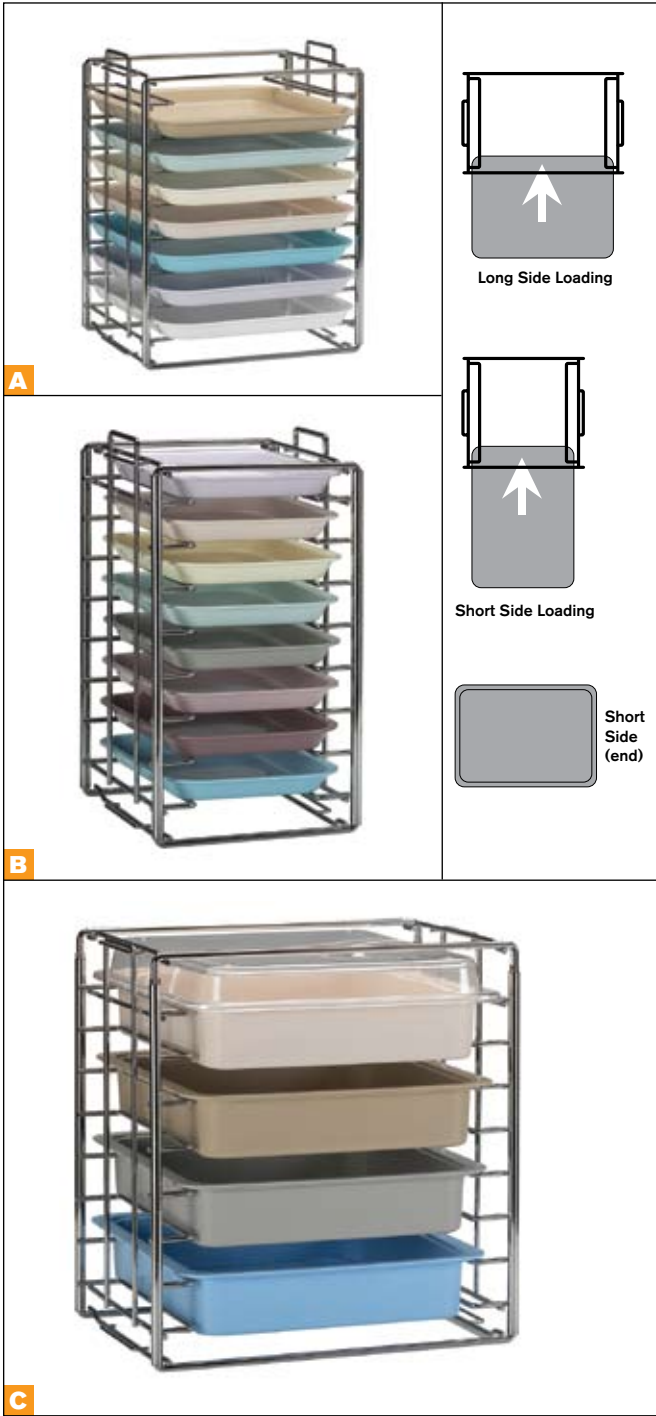

B Trays, Flat

340 x 240 x 22 mm

- A** White ○ 31122 Sea Foam ● 32128
- French Vanilla ○ ... 32125 Lilac ● 32129
- Sand ○ 32126 Baby Blue ● 32130
- Light Mauve ● 32127

- A** Tray Rack, Size B - Short Side Loading 31312
(Accommodates 8 B trays or 16 F Mini Trays)
Minimum cabinet space: 275 x 350 x 360 mm

F Mini Trays, Flat

242 x 170 x 22 mm

- B** White ○ 31142 Sea Foam ● 32147
- French Vanilla ○ ... 32144 Lilac ● 32148
- Sand ○ 32145 Baby Blue ● 32149
- Light Mauve ● 32146

Tray Racks

- Sturdy chromium-plated steel
- Suitable for pass-through use
- Easily assembled without tools
- All racks will accommodate a minimum of 8 trays
- Two-side loading

- B** Tray Rack, Size F (Mini) - Short Side Loading 31304
(Accommodates 8 F (Mini) trays)
Minimum cabinet space: 190 x 250 x 360 mm

Tubs and Accessories

- Portable drawer for organization, storage and transport of support materials used with procedure tray set-ups
- Sturdy plastic construction
- All tubs accommodate a F (mini) tray as an accessory tray on top of the tub
- Auto-/Chemiclavable

S Tub

238 x 292 x 57 mm, with 19 mm lip

- C** French Vanilla ○ ... 31950 Lilac ● 31970
- Sand ○ 31955 Baby Blue ● 31975
- Light Mauve ● 31960 Ice ○ 31985
- Sea Foam ● 31965

S Tub Racks - Side Loading

- Sturdy chromium-plated steel
- Free-standing. Non-stackable
- Suitable for pass-through use
- Easily assembled without tools

- C** S Tub Rack 31580
(Accommodates 4 S Tubs or 3 S Tubs with lid)
Minimum cabinet space: 335 x 250 x 360 mm

Trays and Accessories

Trays

- Constructed of sturdy polypropylene Auto/Chemiclavable plastic
- Non-porous surface resists staining
- Easy to clean and disinfect
- Each component can then be cleaned and sterilized separately or as a set
- Will not decolourise by heat or disinfectants
- 2 sizes, 2 styles and multiple colours are available



S Tub Dividers

8 dividers per package (3 long, 5 short)

D Transparent31940

S Tub Insert, divided

Standard 10-compartment design

E Transparent 31990

S Tub Lid

■ Transparent31526

Bur Blocks

- Magnetic
- Accessible storage for all types of rotary cutting instruments
- Sturdy polypropylene plastic construction
- Can be ultrasonically cleaned, are compatible with most chemical disinfectants
- Auto-/Chemiclavable
- Three capacities: 8, 14, or 24 burs, accepts all shank sizes
- Right angle and Friction Grip
- Available in 7 colours

8-Hole Round Bur Block

40 mm diameter, capacity 8

F White ○31002 Sea Foam ○31823
 French Vanilla ○ ...31820 Lilac ○31824
 Sand ○31821 Baby Blue ○31825
 Light Mauve ○31822

24-Hole Round Bur Block

70 mm diameter, capacity 24

G White ○31007 Sea Foam ○31833
 French Vanilla ○ ...31830 Lilac ○31834
 Sand ○31831 Baby Blue ○31835
 Light Mauve ○31832

14-Hole Rectangular Bur Block

Capacity 14

■ White ○31801
H French Vanilla ○ ...31813 Baby Blue ○31818
 Light Mauve ○31815
I Sand ○31814 Lilac ○31817
 Sea Foam ○31816



X-Ray Viewer

Luminator™ Slim-Line X-Ray Viewer

- Modern Slim-Line styling accepts Panoramic films and intraoral film mounts
- Universal design allows function as desk viewer or wall mount
- All-plastic construction (wet films will not rust viewer)
- Film and mounts are easily secured by top/side clip
- Easy accessibility to lamps and wiring
- Viewing area: 340 mm x 150 mm
- Size 431 x 50 x 209 mm

J Luminator (Ivory)31323

Mirrors

Sterilizable mirror

- Can be Auto-/Chemoclaved and ultrasonically cleaned
- Highest quality rhodium plated front surface mirror to eliminate double image
- Lightweight glass-filled plastic handle
- Comfortable, non-slip grip
- Compatible with most chemical disinfectants
- Can be used during electro surgery
- Size #4 (206 mm diameter)
- Package of 10

K White ○ 31075

ALPHABETICAL INDEX

β-Tron Hydroprocessor	6	Knitted Retraction Cord	22
AeroSpense, Dispensing System	17	Luminator	31
Alginate	3	Mirrors	31
Alginator, Accessories	4	Mixing machine	4
AutoMix Syringe	25, 26	Needles	5, 7
Bib-Eze	18, 19	Non-Eugenol	25, 26
Bib Holders	18	Orange Solvent	17
Braided Retraction Cord	21, 22	PeelVue+	13, 14, 15, 16
Bur Blocks	30	PrepWet	11
CartriLoids	7	Retraction Material	21, 22, 23
Citro-Gold Solvent	17	Reversible Hydrocolloid	5
Clean & Lube Spray	4, 10	Rim-Lock	8
Dispenser Straw	11	ShortCut	21
DryProcessor II	5	Spatula	4
Electrolytic Freshener	11	Sterilizing Pouches	13
Eugenol,	25, 26	Steri-Cage	17
Extend-A-Pour	5, 10	Styptin	23
F Mini Trays	29	SuperCartriLoids	7
Freshner	11	Tacky Stops	10
Gel-Coated	22	Temporary Cements	25, 26, 27
GingiBraid+	22	Trays	29
GingiGel	22	Tubs	29
GingiKnit	23	X-Ray Viewer	31
Haemostatic solution	23	Zinc Oxide	25, 26
Heavy Bodied	5	ZONE	25
HVE Adaptor	10	ZONEfree	26, 27
Hydrocolloid Starter Package	8		
Image Alginate, Image Alginate Singles	3		
Image Syringable	5		
Impression Taking Accessories	10		

