



Sofia²
Lyme FIA

Testing for Lyme Disease

What you need to know

Lyme disease affects more than 300,000 people each year.¹

There are more than 2.4 million patient specimens tested for Lyme annually²

The CDC recommends a two-tier testing algorithm for testing for Lyme Disease.³

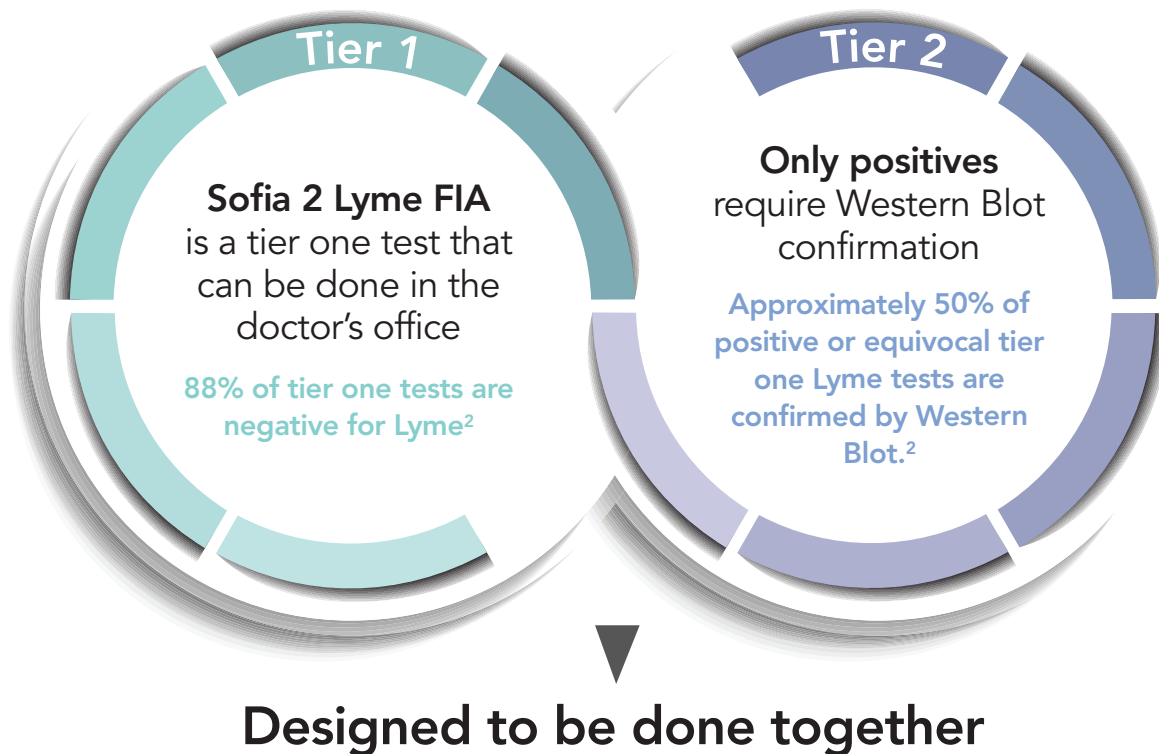

Who should you test?

Only symptomatic patients with possible exposure to infected ticks.

Physicians may need to change the way they currently order Lyme testing.



¹ <https://www.cdc.gov/lyme/stats/humancases.html>

² Hinckley, A. et al. Lyme Disease Testing by Large Commercial Laboratories in the United States, Clinical Infectious Diseases, Volume 59, Issue 5, 1 September 2014, Pages 676-681, <https://doi.org/10.1093/cid/ciu397>

³ <https://www.cdc.gov/lyme/diagnostesting/labtest/twostep/index.html>



Sofia² Lyme FIA

Testing for Lyme Disease What you need to know

Sofia 2 Lyme FIA: CLIA-waived results in minutes, not days.

- Differentiated IgM and IgG results with a single test and dual reimbursement
- Objective and automated results in as few as 3 minutes with no equivocal zone
- CLIA-waived for finger-stick whole blood samples
- Room temperature storage
- 18-month shelf life from date of manufacture

Procedure: Finger-stick Whole Blood

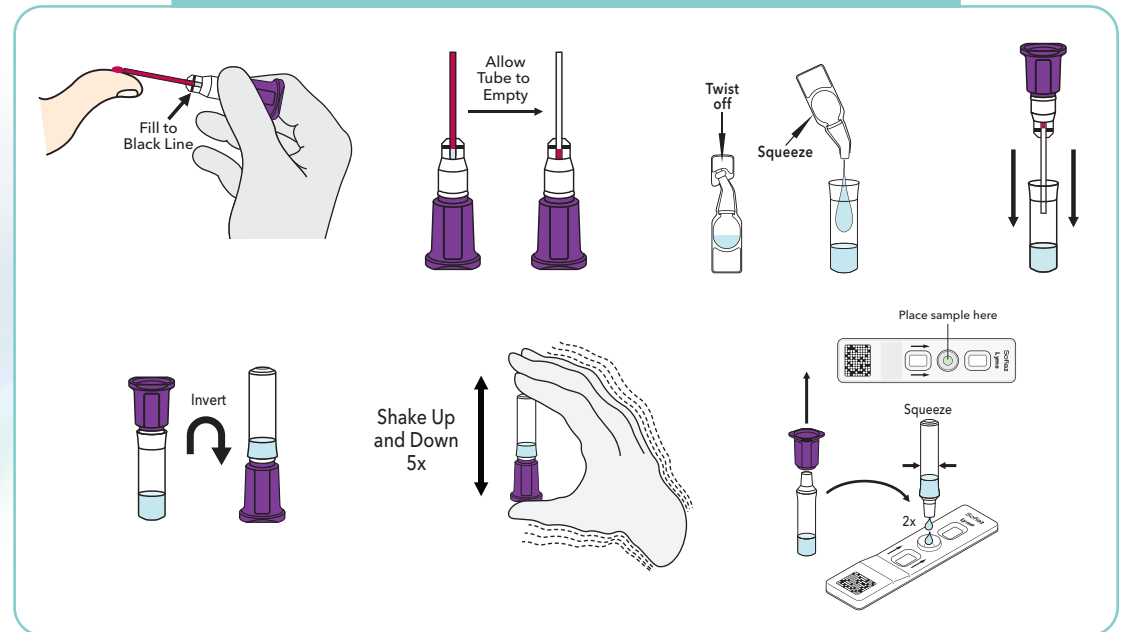

Ordering Information

Sofia 2 Lyme FIA
15 Test Kit – Cat. #20319

Sofia 2 Lyme FIA Starter Kit
1 Pack – Cat. #20320



Medicare 2019 National Limit*

IgM – CPT 86618QW	\$18.92
IgG – CPT 86618QW, 59	\$18.92

Total for both \$37.84

*This information is being provided as a reference, for informational purposes only, with no expressed or implied warranty and does not purport to provide legal or certified coding advice. Under Federal and State law, it is the individual provider's responsibility to determine appropriate coding, charges and claims for a particular service. Policies regarding appropriate coding and payment levels can vary greatly from payer to payer and change over time. Quidel corporation strongly recommends that providers contact their contracted payers to determine appropriate coding and charge or payment levels prior to submitting claims.

